

***SVL-4023******PART LIST MANUAL******VER : 1.0*****WARNING**

Persons unable to read English must have this manual read and explained to them before operating or maintaining the machine. Everyone working on the machine must know how to operate it safely and correctly to avoid possible injury.

1、	BASE ASSEMBLY UNIT	2
2、	COLUMN ASSEMBLY UNIT	4
3、	HEADSTOCK ASSEMBLY UNIT	6
4、	SADDLE ASSEMBLY UNIT	10
5、	WORKTABLE ASSEMBLY UNIT	13
6、	X-AXIS BALLSCREW ASSEMBLY UNIT	15
7、	Y-AXIS BALLSCREW ASSEMBLY UNIT	18
8、	Z-AXIS BALLSCREW ASSEMBLY UNIT	21
9、	OIL COOLER ASSEMBLY UNIT	24
10、	TURNTABLE TOOL MAGAZINE ASSEMBLY UNIT	26
11、	TURNTABLE TOOL MAGAZINE SHEET METAL ASSEMBLY UNIT	28
12、	FRONT DOOR ASSEMBLY UNIT	30
13、	MACHINERY COVERS ASSEMBLY UNIT	33
14、	POWER CANINET ASSEMBLY UNIT	37
15、	FRONT COOLANT TANK ASSEMBLY UNIT	40
16、	COOLANT TANK ASSEMBLY UNIT	42
17、	OPERATION BOX ASSEMBLY UNIT	44
18、	SPINDLE HEAD SHEET METAL ASSEMBLY UNIT	47

### 1、BASE ASSEMBLY UNIT

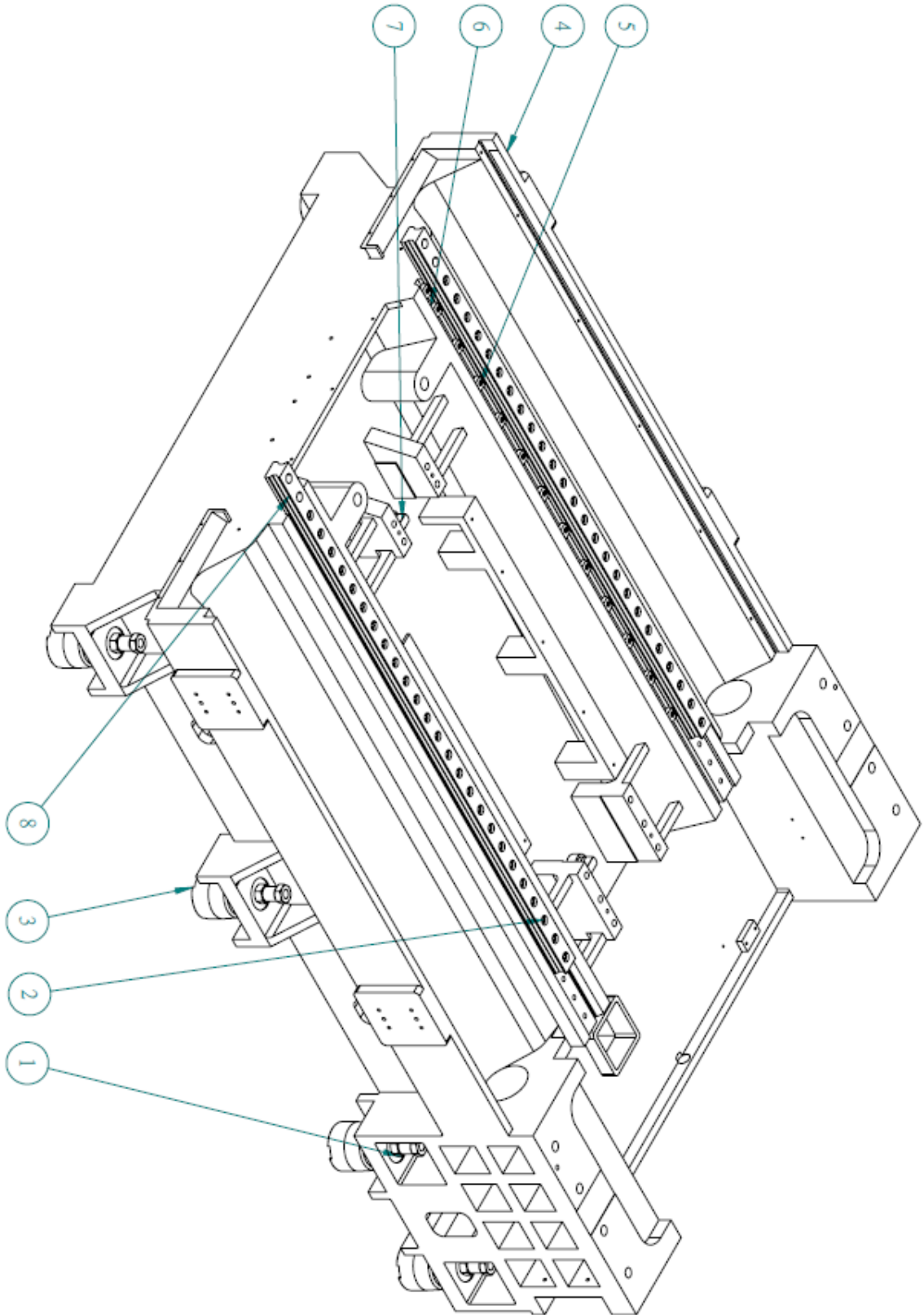



**PART LIST MANUAL**  
**SVL-4023 VERTICAL MACHINING CENTER**

NO.	PART NO.	PART NAME	SPECIFICATION	Q'TY	UNIT
1	C2088001600	Foundation Screw+Nut	M30xP2.0x120L	8	EA
2	D0000070456	Hexagon Socket Head Cap Screws	M12xP1.75x45L	50	EA
3	A2044000401	Foundation Block	FC250	8	EA
4	A2040000201	BASE	FC300	1	EA
5	D0000040206	Hexagon Socket Head Cap Screws	M6xP1.0x20L	26	EA
6	C2088001100	Guide	T2	26	EA
7	A2051001301	Positioning Shaft	D35x56L	2	EA
8	C2052000200	Y AXIS Linear Guide	MSR45LS2SSF2A+R1 415-25/25HII	1	SET

### 2、 COLUMN ASSEMBLY UNIT

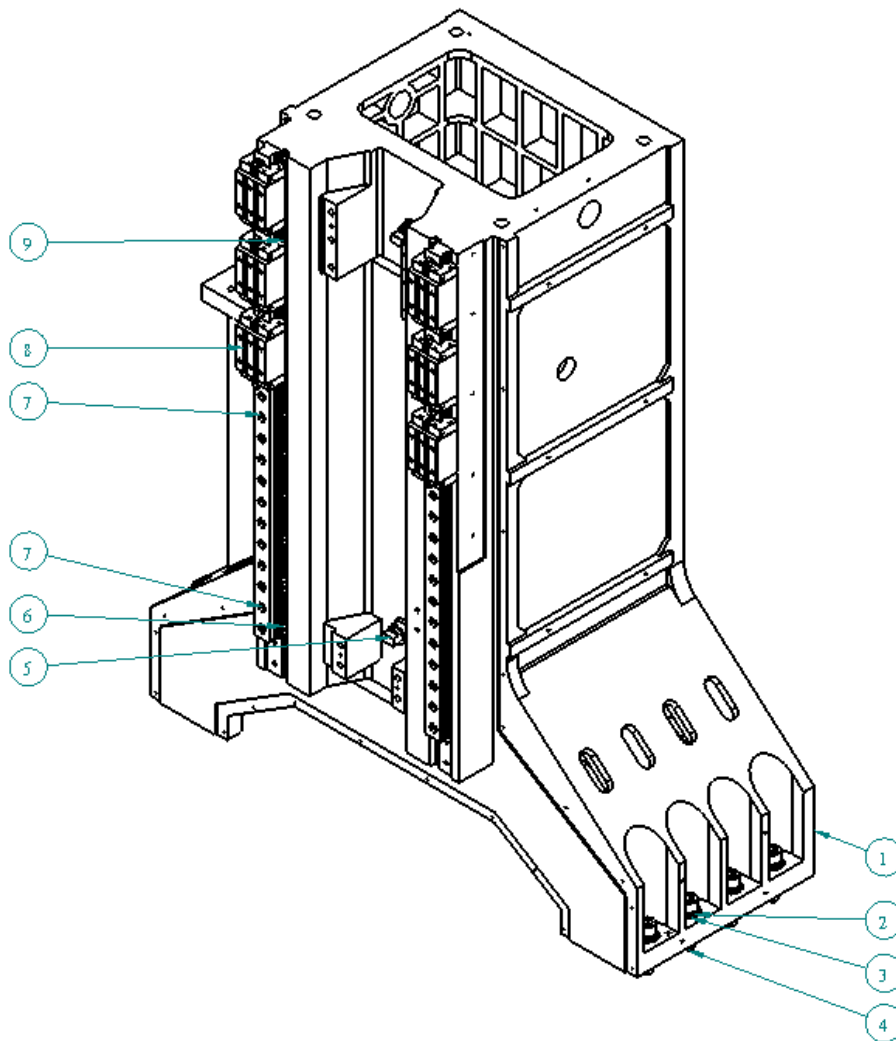



**PART LIST MANUAL**  
**SVL-4023 VERTICAL MACHINING CENTER**

No.	PART NO.	PART NAME	SPECIFICATION	Q'TY	UNIT
1	A2010000202	Column	FC300	1	EA
2	D0011130401	Spring Washer	M24	8	EA
3	D0010230441	Washer	D44xd226x4.5T	8	EA
4	D0000131001	Hexagon Socket Head Cap Screws	M24xP3.0x100L	8	EA
5	A2051001301	Positioning Shaft	D35x56L	2	EA
6	D0000040206	Hexagon Socket Head Cap Screws	M6xP1.0x20L	24	EA
7	D0000050456	Hexagon Socket Head Cap Screws	M12xP1.75x45L	46	EA
8	C2053000400	Z Axis Linear Guides	MSR45S3SSF2A+R1205- 25/25HII	1	SET
9	C2088001100	Guide	T2	24	EA

### 3、HEADSTOCK ASSEMBLY UNIT

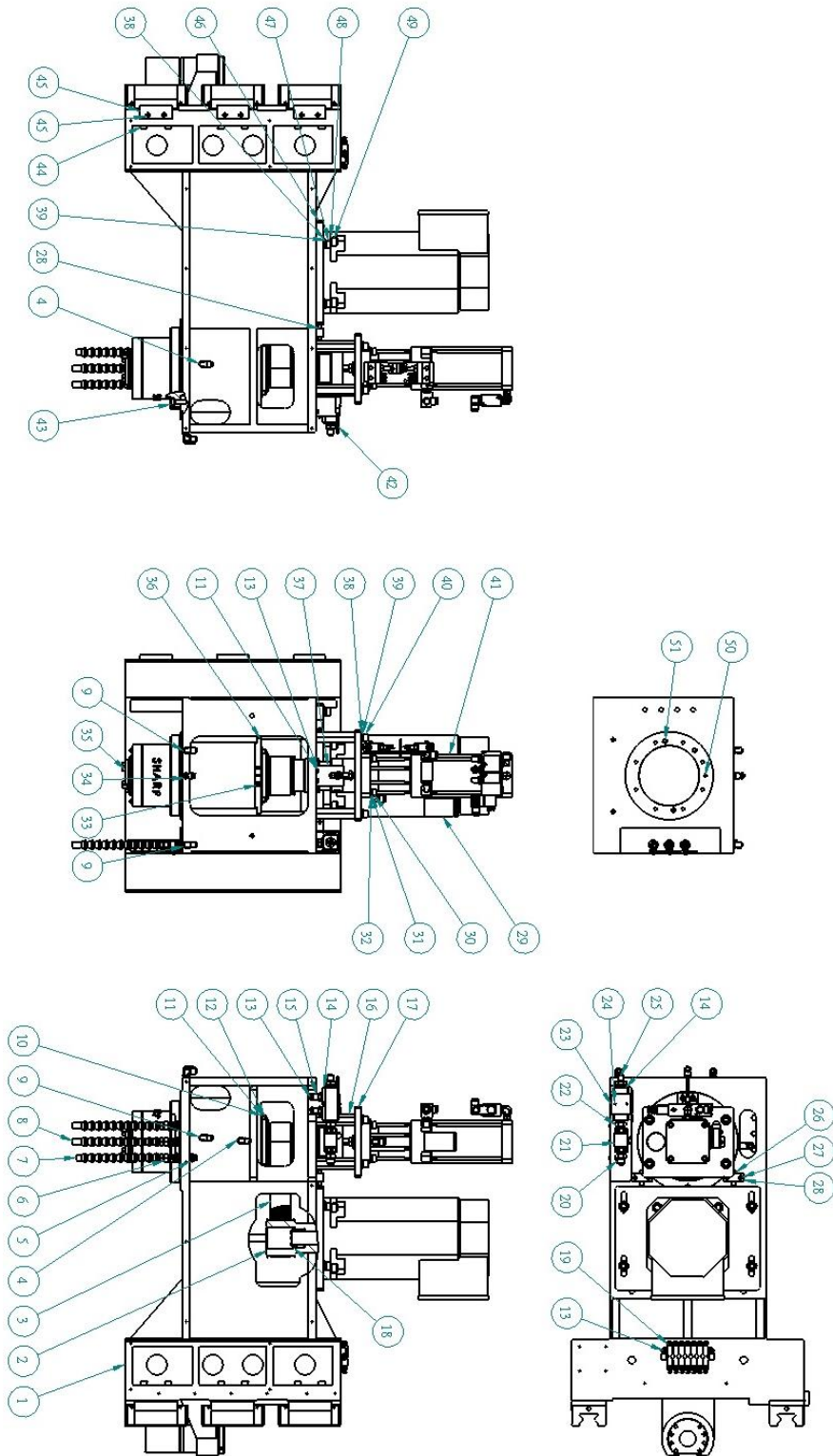



**PART LIST MANUAL**  
**SVL-4023 VERTICAL MACHINING CENTER**

NO.	PART NO.	PART NAME	SPECIFICATION	Q'TY	UNIT
1	A200000202	Headstock	946Lx580Wx540H	1	EA
2	C2004006100	Pully	5GT-60T	1	EA
3	C2004006200	Belt	5GT-780L-50W	1	EA
4	C0062000938	Hydraulic Fittings	PT 1/4xPH 3/8 90~	2	EA
5	C0061000033	One-Touch Couplings	PC08-03	1	EA
6	C0062000763	Ball Valve	3/8"	3	EA
7	C0062000258	ADJUSTABLE COOLANT NOZZLES	PT3/8x12-n6mm	1	EA
8	C0062000917	ADJUSTABLE COOLANT NOZZLES	PT3/8x12-n9mm	2	EA
9	C0062000066	Hydraulic Fittings	PT 1/4XPH 3/8 90~	3	EA
10	D0010041001	Washer	M6	8	EA
11	D0011040906	Spring Washer	M6	8	EA
12	D0000040256	Hexagon Socket Head Cap Screws	M6xP1.0x25L	4	EA
13	D0000040166	Hexagon Socket Head Cap Screws	M6xP1.0x16L	12	EA
14	C0062000010	Shunt Block	3/8"PTx1/2"PT	1	EA
15	C2062001400	T+H Hydraulic Fittings	PT3/8xPH3/8	2	EA
16	A2002001000	Boosting Unclamping Cylinder Pillar	103L	4	EA
17	A2002000201	Boosting Unclamping Cylinder Base	227Lx176Wx15H	1	EA





**PART LIST MANUAL**  
**SVL-4023 VERTICAL MACHINING CENTER**

NO.	PART NO.	PART NAME	SPECIFICATION	Q'TY	UNIT
18	C2004006000	Self Centering	SMA-32	1	EA
19	C2063000200	Volume Distributor	RH-7 0.1cc x6 孔+0.3cc	1	EA
20	C0062000024	T+H Hydraulic Fittings	PT1/2xPH1/2	1	EA
21	C0062000852	Back Pressure Valve	PT1/2	1	EA
22	C0062000932	T+T Hydraulic Fittings	PT1/2xPT1/2	1	EA
23	B2071015300	Shunt Block Plate	55Lx50Wx25H	1	EA
24	D0000030406	Hexagon Socket Head Cap Screws	M5xP0.8x40	2	EA
25	C0062000033	T+H Hydraulic Fittings	1/2TX3/8H	1	EA
26	D003060406	Hexagon Socket Screws	M10xP1.5x40	2	EA
27	D0000040206	Hexagon Socket Head Cap Screws	M6xP1.0x20L	4	EA
28	A2004000500	Block	50Lx20Wx20H	2	EA
29		Spindle Motor	[FANUC]B8/12000	1	EA
30	D0000060406	Hexagon Socket Head Cap Screws	M10xP1.5x40L	4	EA
31	D0011062226	Spring Washer	M10	4	EA
32	D0010062306	Washer	M10	4	EA
33	D0000040356	Hexagon Socket Head Cap Screws	M6xP1.0x35L	1	EA
34	C0061000017	One-Touch Couplings	SPL8-01	1	EA



## PART LIST MANUAL SVL-4023 VERTICAL MACHINING CENTER

NO.	PART NO.	PART NAME	SPECIFICATION	Q'TY	UNIT
35	C2004005700	Spindle	[SETCO]531A570,BVC40 *12K*5GT-60T	1	EA
36	A2001000401	Fixed Ring	D190xd150x15H	1	EA
37	B2071014900	Switch Plate	75Lx60Wx50H	1	EA
38	D0010071801	Washer	M12	8	EA
39	D0011070021	Spring Washer	M12	8	EA
40	D0000070306	Hexagon Socket Head Cap Screws	M12xP1.75x30L	4	EA
41	C0002000800	Boosting Unclamping Cylinder	4500kgX13m/m	1	EA
42	E0082005100	Proximity Sensor	E2E2-X2B2 2M	1	EA
43	D0000060306	Hexagon Socket Head Cap Screws	M10xP1.5x30L	8	EA
44	D0000060556	Hexagon Socket Head Cap Screws	M10xP1.5x55	36	EA
45	A2053000801	Block	80Lx35Wx12H	3	EA
46	A2004000800	Motor Plate	360Lx260Wx20H	1	EA
47	D0000070456	Hexagon Socket Head Cap Screws	M12xP1.75x45L	4	EA
48	D0011080246	Spring Washer	M14	4	EA
49	D0000080401	Hexagon Socket Head Cap Screws	M14xP2.0x40	4	EA
50	C2001000300	O-Ring	P5	1	EA
51	C2001000100	O-Ring	P8	3	EA

### 4、SADDLE ASSEMBLY UNIT

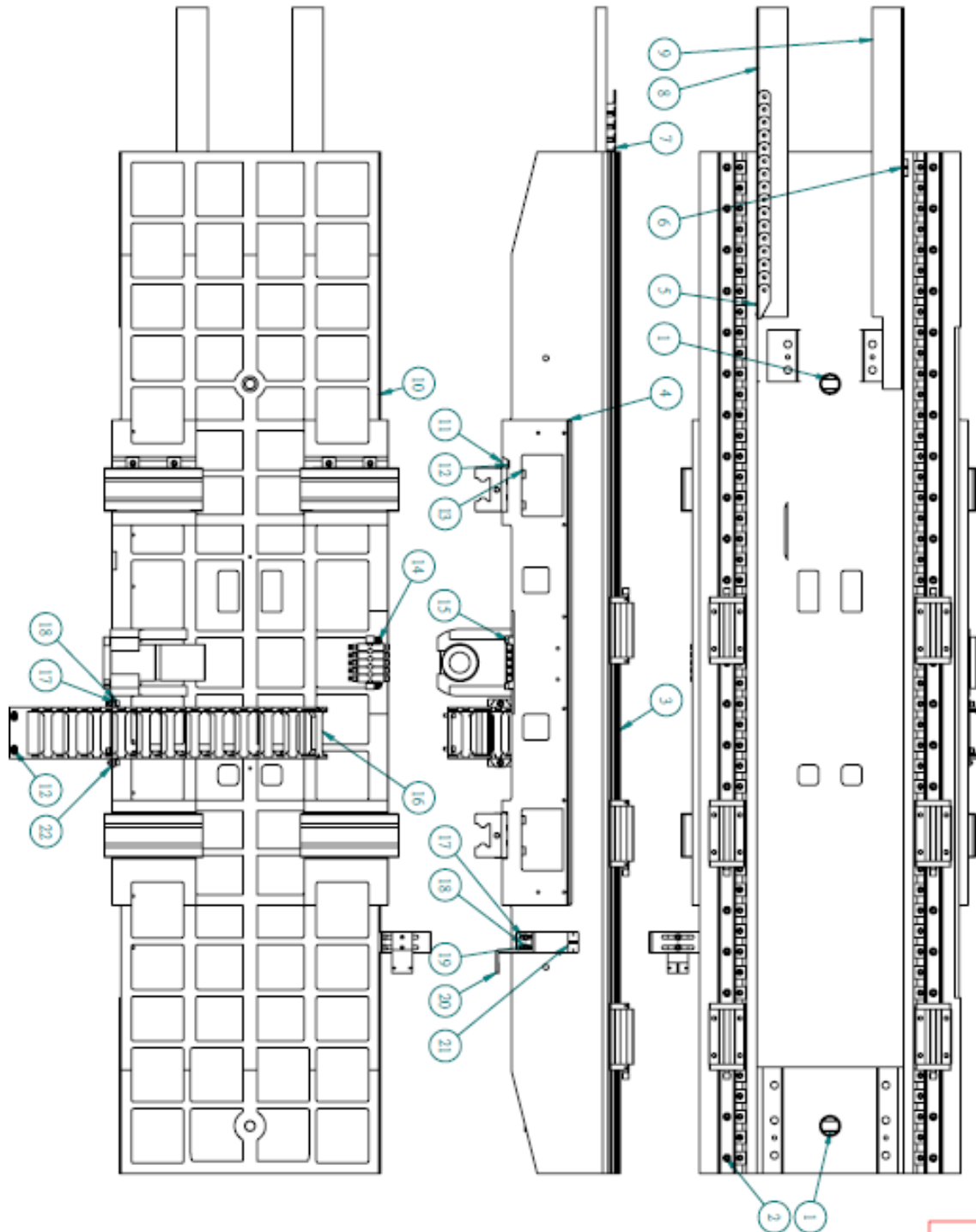



**PART LIST MANUAL**  
**SVL-4023 VERTICAL MACHINING CENTER**

NO.	PART NO.	PART NAME	SPECIFICATION	QTY	UNIT
1	A2051001301	Positioning Shaft	D35x56L	2	EA
2	D0000050306	Hexagon Socket Head Cap Screws	M8xP1.25x30L	98	EA
3	C2051002400	X AXIS Linear Guides	MSA35S3SSF1A+R1980-30/30HII	1	SET
4		O-Ring	Ø2.4x940L	2	EA
5	D0000040206	Hexagon Socket Button Head Cap Screws	M6xP1.0x10L	2	EA
6	D0002030106	Socket Head Cap Screws	M5xP0.8x10L	6	EA
7	E2082005200	X AXIS Square Protective Tube	SQ603-III-KR75-1128L-NO4(47)	1	SET
8	B2071014400	X AXIS Square Protective Tube Plate	600Lx60Wx37H	1	EA
9	B2071014500	X AXIS Square Protective Tube Plate	740Lx60Wx37H	1	EA
10	A2020000201	Saddle	1980Lx537Wx325H	1	EA
11	C2088001100	Guide	T2	102	EA
12	D0000040166	Hexagon Socket Head Cap Screws	M6xP1.0x16L	112	EA
13	D0000030126	Hexagon Socket Head Cap Screws	M10xP1.5x40L	16	EA
14	D0000030126	Hexagon Socket Head Cap Screws	M5xP0.8x12L	2	EA
15	C2163000100	Volume Distributor	RH-5 0.1cc x4 孔+0.3cc x1 孔	1	EA
16	E2082000800	Wire Conduit , Y Axis	SQ604-V-KR40-960L-NO9(20)	1	SET
17	D0010041001	Washer	M6	12	EA



**PART LIST MANUAL**  
**SVL-4023 VERTICAL MACHINING CENTER**

NO.	PART NO.	PART NAME	SPECIFICATION	QTY	UNIT
18	D0011040906	Spring Washer	M6	10	EA
19	B2070000700	X AXIS Origin	L120xW100xH40	1	EA
20	B2070000800	X AXIS Origin	L80xW75xH40	1	EA
21	F0000000879	Grid Origin Plate	L40xW20xH1	2	EA
22	B2071014600	Plate	130Lx84Wx3H	1	EA

### 5、WORKTABLE ASSEMBLY UNIT

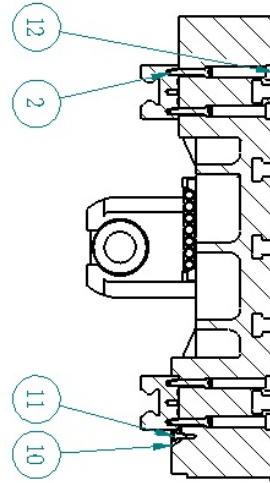
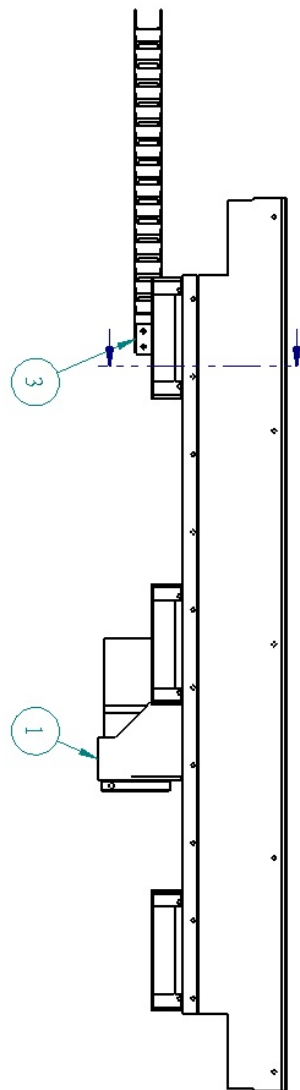
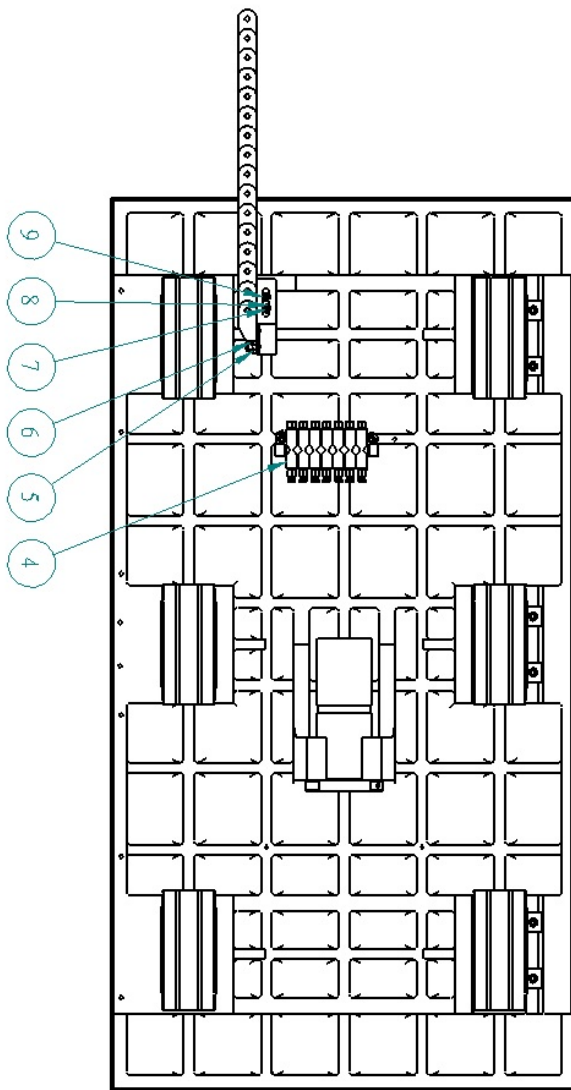



**PART LIST MANUAL**  
**SVL-4023 VERTICAL MACHINING CENTER**

NO.	PART NO.	PART NAME	SPECIFICATION	Q'TY	UNIT
1	A2030000202	Worktable	1150Lx600Wx243H	1	EA
2	D0000050456	Hexagon Socket Head Cap Screws	M8xP1.25x45L	24	EA
3	B2071014700	Fixed Plate	100Lx95Wx25H	1	EA
4	C2063000200	Volume Distributor	RH-7 0.1cc x6HOLE+0.3cc x1HOLE	1	EA
5	D0010041001	Washer	M6	2	EA
6	D0011040906	Spring Washer	M6	2	EA
7	D0000030126	Hexagon Socket Head Cap Screws	M5xP0.8x12L	4	EA
8	D0010031206	Washer	M5	2	EA
9	D0011030806	Spring Washer	M5	2	EA
10	C2088001100	Guide	T2	6	EA
11	D0000040126	Hexagon Socket Head Cap Screws	M6xP1.0x12L	8	EA
12	C2088002800	Plug Cover	D18(THK C10)	24	EA

### 6、X-AXIS BALLSCREW ASSEMBLY UNIT

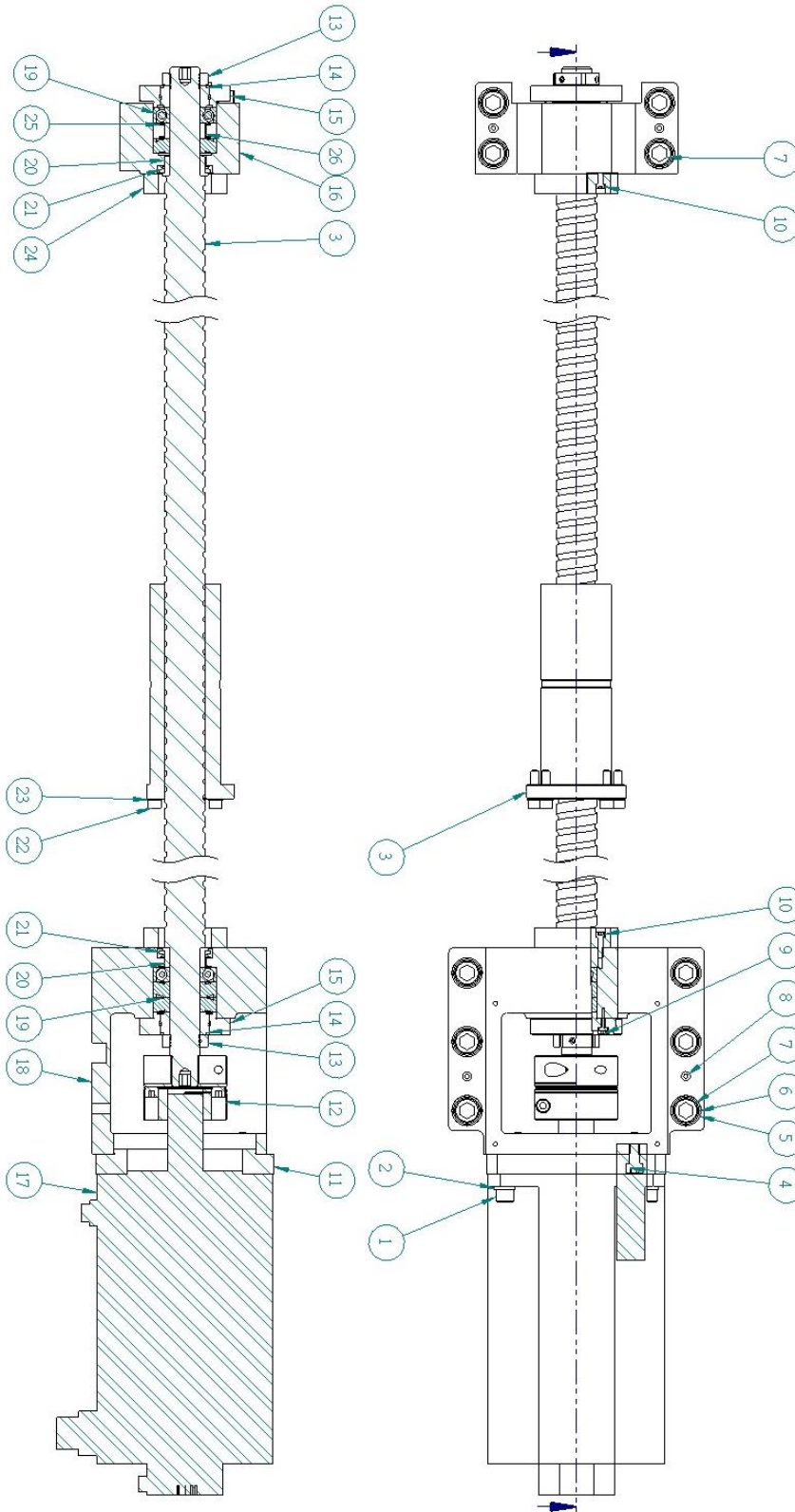





**PART LIST MANUAL**  
**SVL-4023 VERTICAL MACHINING CENTER**

NO.	PART NO.	PART NAME	SPECIFICATION	QTY	UNIT
1	D0000070306	Hexagon Socket Head Cap Screws	M12xP1.75x30L	4	EA
2	D0011070021	Spring Washer	M12	4	EA
3	C2051002300	X AXIS Ballscrews	1R40-16T5-1FDDC-1339-1583-0.008	1	SET
4	D0000060306	Hexagon Socket Head Cap Screws	M10xP1.5x30L	4	EA
5	D0010092401	Washer	M16	10	EA
6	D0011090026	Spring Washer	M16	10	EA
7	D0000090606	Hexagon Socket Head Cap Screws	M16xP2.0x60L	10	EA
8	D0016340455	Slide Pin	1/50-D8-45L-M5	4	EA
9	D0000040206	Hexagon Socket Head Cap Screws	M6xP1.0x20L	8	EA
10	D0000030206	Hexagon Socket Head Cap Screws	M5xP0.8x20L	8	EA
11	A2051000500	Motor Base Adapter Plate	176Lx176Wx25H	1	EA
12	C0050002200	Coupling	SHS-82C D35-D25	1	EA
13	C0088010900	Precision Locknut	YSR M30x1.5	2	EA
14	A2051000700	Laminal Ring	D48x22H	2	EA
15	A2051000801	Bearing Cap	D90x22L	2	EA
16	A2051000401	Rear Bearing Housing	200Lx118Wx114H	1	EA



**PART LIST MANUAL**  
**SVL-4023 VERTICAL MACHINING CENTER**

NO.	PART NO.	PART NAME	SPECIFICATION	QTY	UNIT
17		Server Motor	β30-2000iB	1	
18	A2051000300	Transmission Housing	204Lx252Wx172H	1	EA
19	C0088008300	Bearing	30TAC62CSUHPN5D	5	EA
20	A2051000601	Bearing Spacer	D45x19H	2	EA
21	C0088008400	C type O-Ring	V-40A	2	EA
22	D0000050306	Hexagon Socket Head Cap Screws	M8xP1.25x30L	8	EA
23	D0011050146	Spring Washer	M8	8	EA
24	A2051001200	Rubber Cushion	n82x20H	2	SET
25	A2051001100	Bearing Spacer	D40xd30x15H	1	EA
26	A2051001000	Bearing Spacer	D62xd42x15H	1	EA

### 7、Y-AXIS BALLSCREW ASSEMBLY UNIT

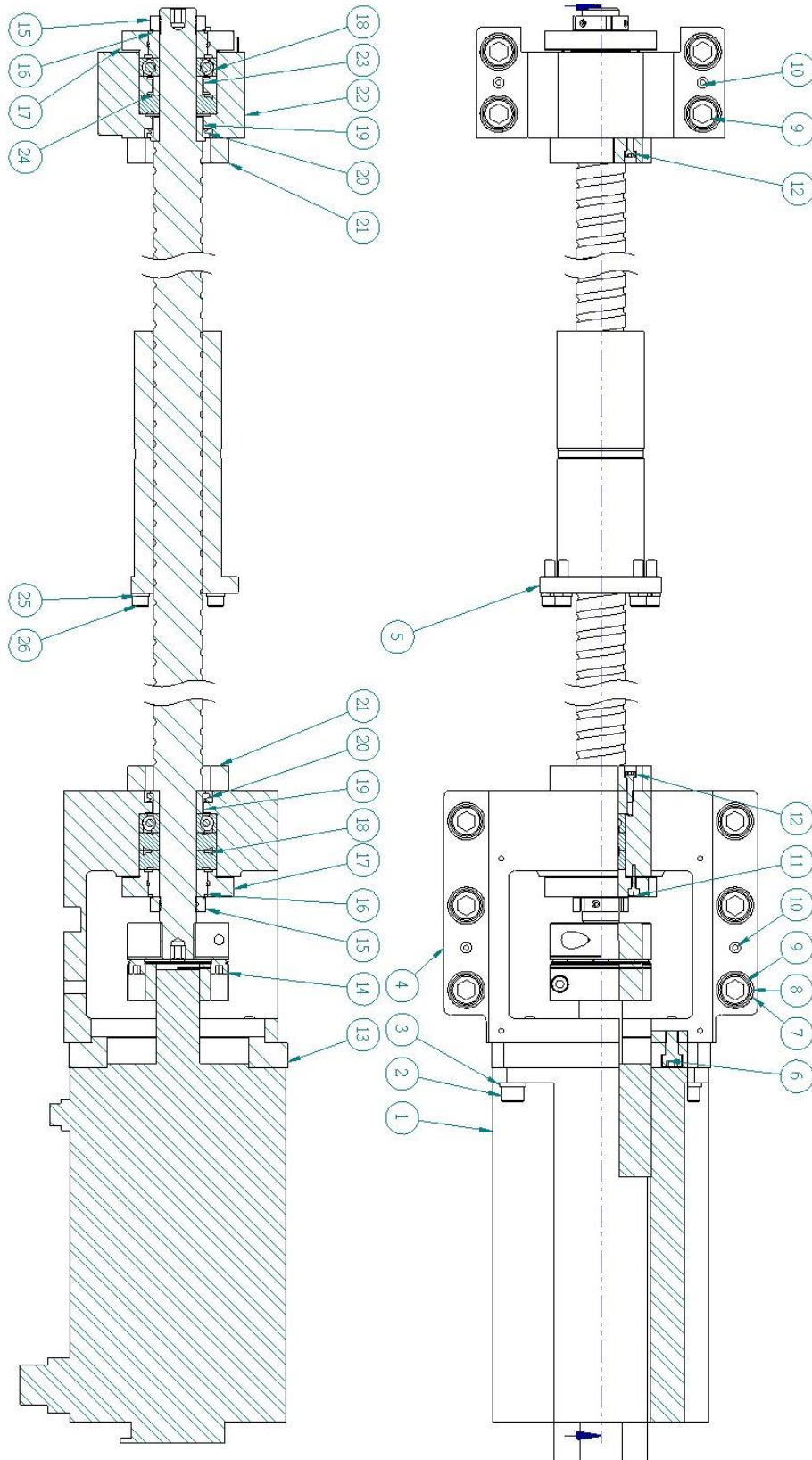



**PART LIST MANUAL**  
**SVL-4023 VERTICAL MACHINING CENTER**

NO.	PART NO.	PART NAME	SPECIFICATION	QTY	UNIT
1		Server Motor	β30-2000iB	1	
2	D0000070306	Hexagon Socket Head Cap Screws	M12xP1.75x30L	4	EA
3	D0011070021	Spring Washer	M12	4	EA
4	A2051000300	Transmission Housing	204Lx252Wx172H	1	EA
5	C2052001600	Y AXIS Ballscrews	1R40-16T5-1FDDC-879- 1123-0.008	1	SET
6	D0000060306	Hexagon Socket Head Cap Screws	M10xP1.5x30L	4	EA
7	D0010092401	Washer	M16	10	EA
8	D0011090026	Spring Washer	M16	10	EA
9	D0000090606	Hexagon Socket Head Cap Screws	M16xP2.0x60L	10	EA
10	D0016340455	Slide Pin	1/50-D8-45L-M5	4	EA
11	D0000040206	Hexagon Socket Head Cap Screws	M6xP1.0x20L	8	EA
12	D0000030206	Hexagon Socket Head Cap Screws	M5xP0.8x20L	8	EA
13	A2051000500	Motor Base Adapter Plate	176Lx176Wx25H	1	EA
14	C0050002200	Coupling	SHS-82C D35-D25	1	EA
15	C0088010900	Precision Locknut	YSR M30x1.5	2	EA
16	A2051000700	Laminal Ring	D48x22H	2	EA



**PART LIST MANUAL**  
**SVL-4023 VERTICAL MACHINING CENTER**

NO.	PART NO.	PART NAME	SPECIFICATION	Q'TY	UNIT
17	A2051000801	Bearing Cap	D90x22L	2	EA
18	C0088008300	Bearing	30TAC62CSUHPN5D	5	EA
19	A2051000601	Bearing Spacer	D45x19H	2	EA
20	C0088008400	C type O-Ring	V-40A	2	EA
21	A2051001200	Rubber Cushion	n82x20H	2	SET
22	A2051000401	Rear Bearing Housing	200Lx118Wx114H	1	EA
23	A2051001100	Bearing Spacer	D40xd30x15H	1	EA
24	A2051001000	Bearing Spacer	D62xd42x15H	1	EA
25	D0011050146	Spring Washer	M8	8	EA
26	D0000050306	Hexagon Socket Head Cap Screws	M8xP1.25x30L	8	EA

### 8、Z-AXIS BALLSCREW ASSEMBLY UNIT

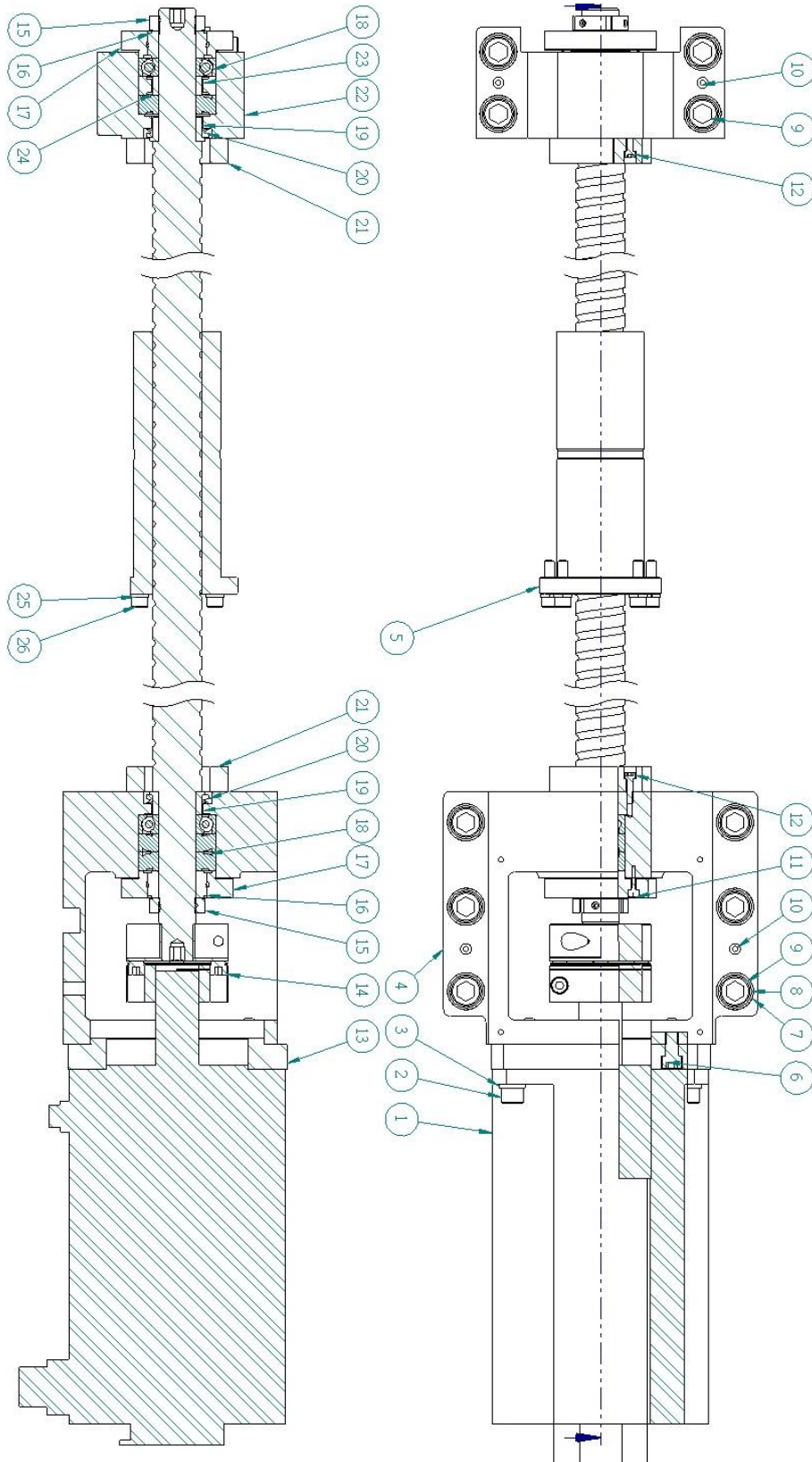



**PART LIST MANUAL**  
**SVL-4023 VERTICAL MACHINING CENTER**

NO.	PART NO.	PART NAME	SPECIFICATION	Q'TY	UNIT
1		Server Motor	β30-2000iB	1	
2	D0000070306	Hexagon Socket Head Cap Screws	M12xP1.75x30L	4	EA
3	D0011070021	Spring Washer	M12	4	EA
4	A2051000300	Transmission Housing	204Lx252Wx172H	1	EA
5	C2052001400	Z AXIS Ball Screws	1R40-20T3-1FDDC-879- 1123-0.008	1	SET
6	D0000060306	Hexagon Socket Head Cap Screws	M10xP1.5x30L	4	EA
7	D0010092401	Washer	M16	10	EA
8	D0011090026	Spring Washer	M16	10	EA
9	D0000090606	Hexagon Socket Head Cap Screws	M16xP2.0x60L	10	EA
10	D0016340455	Slide Pin	1/50-D8-45L-M5	4	EA
11	D0000040206	Hexagon Socket Head Cap Screws	M6xP1.0x20L	8	EA
12	D0000030206	Hexagon Socket Head Cap Screws	M5xP0.8x20L	8	EA
13	A2051000500	Motor Base Adapter Plate	176Lx176Wx25H	1	EA
14	C0050002200	Coupling	SHS-82C D35-D25	1	EA
15	C0088010900	Precision Locknut	YSR M30x1.5	2	EA
16	A2051000700	Laminal Ring	D48x22H	2	EA



**PART LIST MANUAL**  
**SVL-4023 VERTICAL MACHINING CENTER**

NO.	PART NO.	PART NAME	SPECIFICATION	Q'TY	UNIT
17	A2051000801	Bearing Cap	D90x22L	2	EA
18	C0088008300	Bearing	30TAC62CSUHPN5D	5	EA
19	A2051000601	Bearing Spacer	D45x19H	2	EA
20	C0088008400	C type O-Ring	V-40A	2	EA
21	A2051001200	Rubber Cushion	n82x20H	2	SET
22	A2051000401	Rear Bearing Housing	200Lx118Wx114H	1	EA
23	A2051001100	Bearing Spacer	D40xd30x15H	1	EA
24	A2051001000	Bearing Spacer	D62xd42x15H	1	EA
25	D0011050146	Spring Washer	M8	8	EA
26	D0000050306	Hexagon Socket Head Cap Screws	M8xP1.25x30L	8	EA



### 9、OIL COOLER ASSEMBLY UNIT

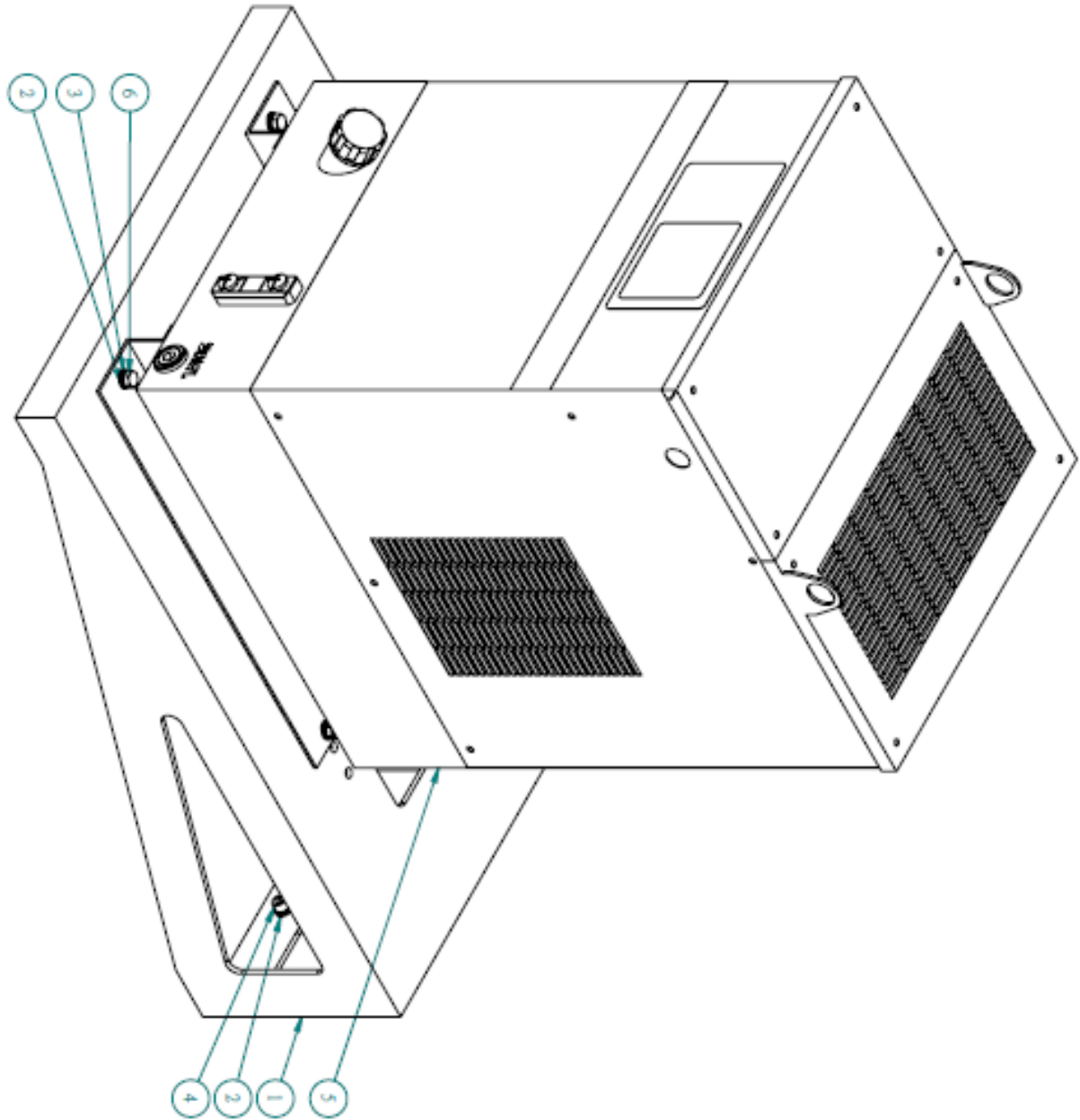



**PART LIST MANUAL**  
**SVL-4023 VERTICAL MACHINING CENTER**

NO.	PART NO.	PART NAME	SPECIFICATION	Q'TY	UNIT
1	B2071024600	Oil Cooler Mount	700Lx490Wx200H	1	EA
2	D0010051301	Washer	M8	8	EA
3	D0011050146	Spring Washer	M8	8	EA
4	D0000050256	Hexagon Socket Head Cap Screws	M8xP1.25x25L	4	EA
5	C0088000100	Oil Cooler	C04PTS	1	EA
6	D0005050256	Hexagon Bolts	M8xP1.25x25L	4	EA

### 10 · TURNTABLE TOOL MAGAZINE ASSEMBLY UNIT

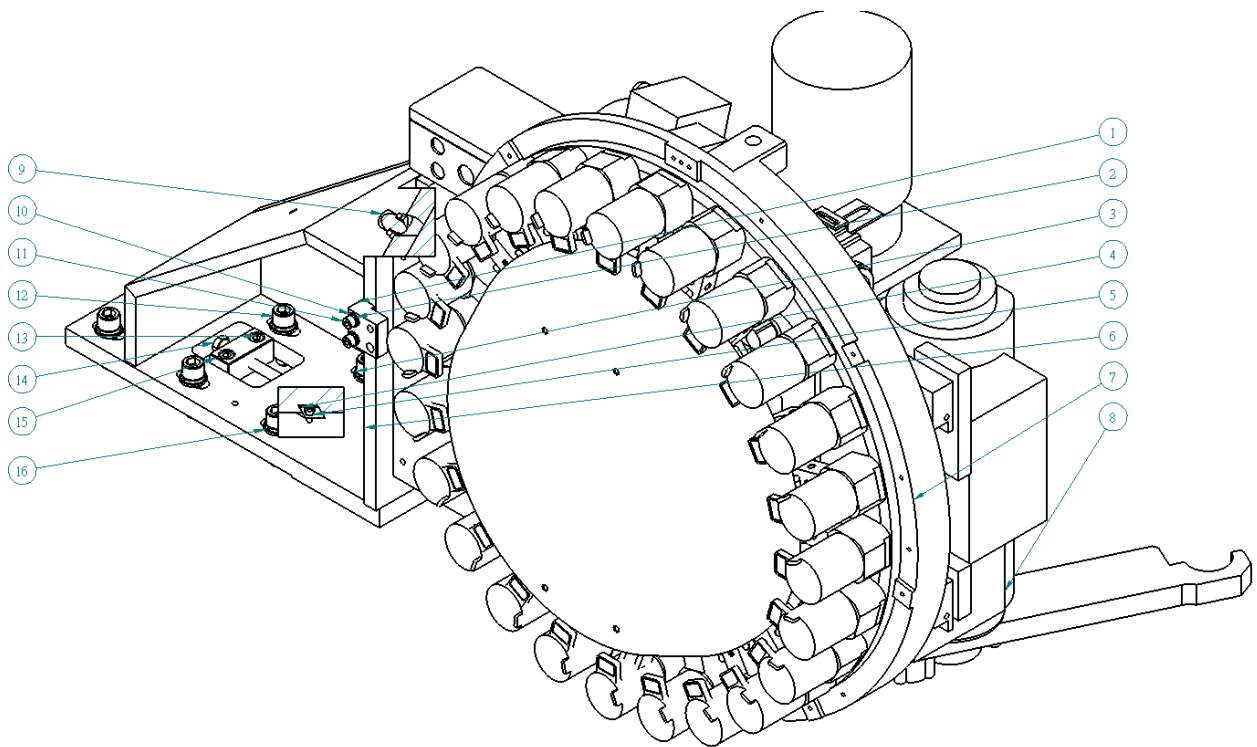



**PART LIST MANUAL**  
**SVL-4023 VERTICAL MACHINING CENTER**

NO.	PART NO.	PART NAME	SPECIFICATION	Q'TY	UNIT
1	A2084000300	Interface Seat Adjustment Block	45Lx45Wx24H	1	EA
2	D0010051301	Washer	M8	2	EA
3	D0011090026	Spring Washer	M16	10	EA
4	A0184000400	Double head round keys	35Lx15Wx10H	2	EA
5	D0000040126	Hexagon Socket Head Cap Screws	M6xP1.0x12L	2	EA
6	C2084000200	Interface Seat	485Lx420Wx225H	1	EA
7	C2084003000	Turntable Tool Magazine	MR4AKF411D01-01	1	SET
8	C2084000800	Automatic Tools Changer	65° /1:10/220V/42DEXA101A	1	SET
9	D0000080401	Hexagon Socket Head Cap Screws	M14xP2.0x40	4	EA
10	D0011050146	Spring Washer	M8	2	EA
11	D0000050406	Hexagon Socket Head Cap Screws	M8xP1.25x40L	2	EA
12	D0000090556	Hexagon Socket Head Cap Screws	M16xP2.0x55L	6	EA
13	D0000060306	Hexagon Socket Head Cap Screws	M10xP1.5x30L	2	EA
14	D0023070906	Hexagon Bolts	M12xP1.75x90L	1	EA
15	A2084000100	Interface Seat Adjustment Block	70Lx30Wx30H	1	EA
16	D0010092401	Washer	M16	10	EA

### 11、TURNTABLE TOOL MAGAZINE SHEET METAL ASSEMBLY UNIT

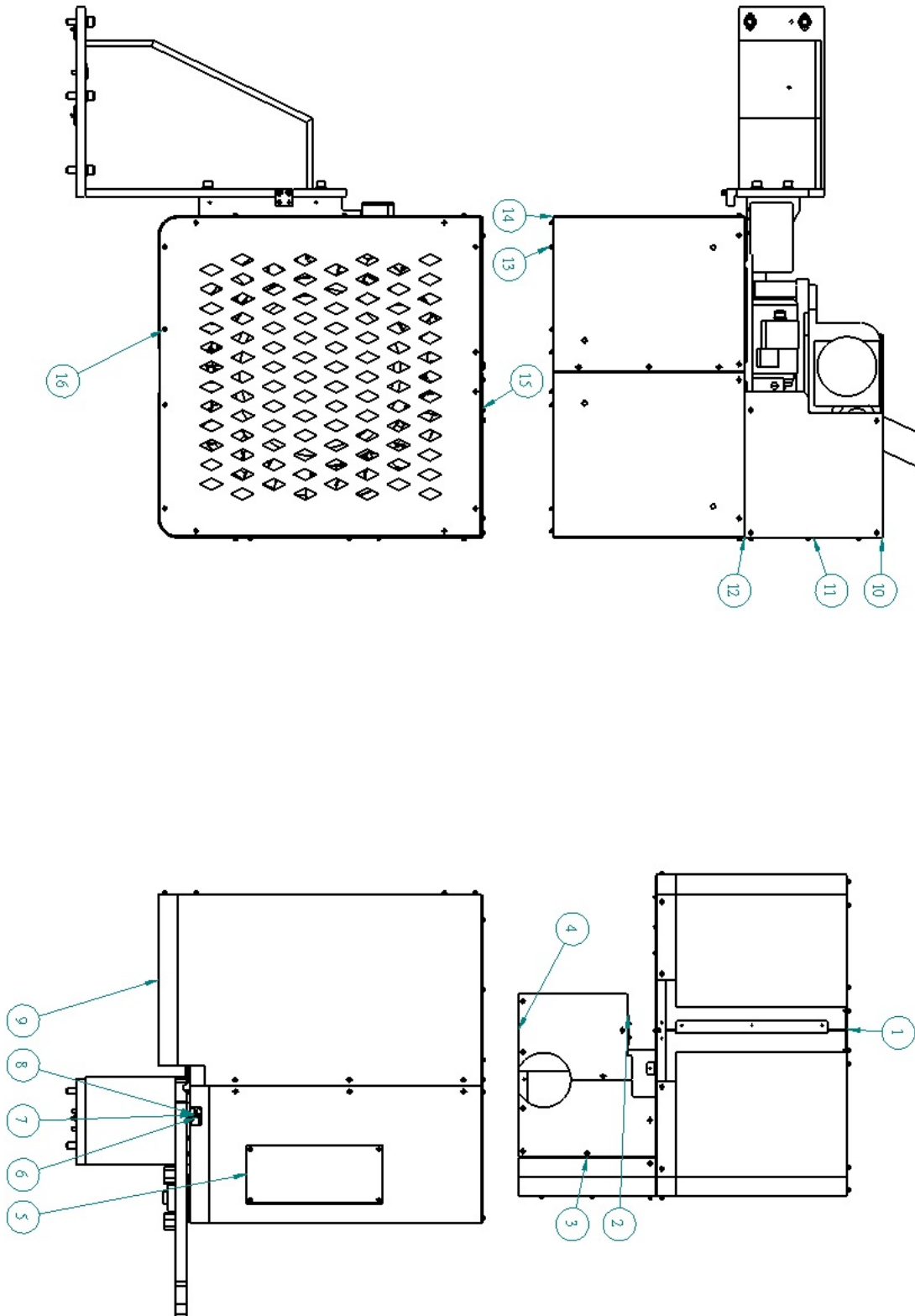



**PART LIST MANUAL**  
**SVL-4023 VERTICAL MACHINING CENTER**

NO.	PART NO.	PART NAME	SPECIFICATION	Q'TY	UNIT
1	B2071019300	Cover	822.5Lx816Wx2H	1	EA
2	B2071019000	Rear Fixed Plate	80Lx30Wx28H	1	EA
3	B2071018800	Lower Cover	353Lx198Wx2H	1	EA
4	B2071018900	Rear Lower Cover	279Lx222Wx2H	1	EA
5	B2077000300	Acrylic Plate	348Lx148Wx2H	1	EA
6	D0000040126	Hexagon Socket Head Cap Screws	M6xP1.0x12L	2	EA
7	D0011040906	Spring Washer	M6	2	EA
8	D0010041001	Washer	M6	2	EA
9	B2071019100	Right Cover	830.5Lx490Wx449.5H	1	EA
10	B2071018700	Rear Cover	747Lx520Wx353H	1	EA
11	B2071018600	Upper Cover	375Lx353Wx2H	1	EA
12	B2071018500	Disc Cover	820Lx745Wx50H	1	EA
13	D0000030126	Hexagon Socket Head Cap Screws	M5xP0.8x12L	56	EA
14	B2071019200	Left Cover	830.5Lx485Wx449.5H	1	EA
15	D0010031206	Washer	M5	56	EA
16	D0011030806	Spring Washer	M5	52	EA

### 12 · FRONT DOOR ASSEMBLY UNIT

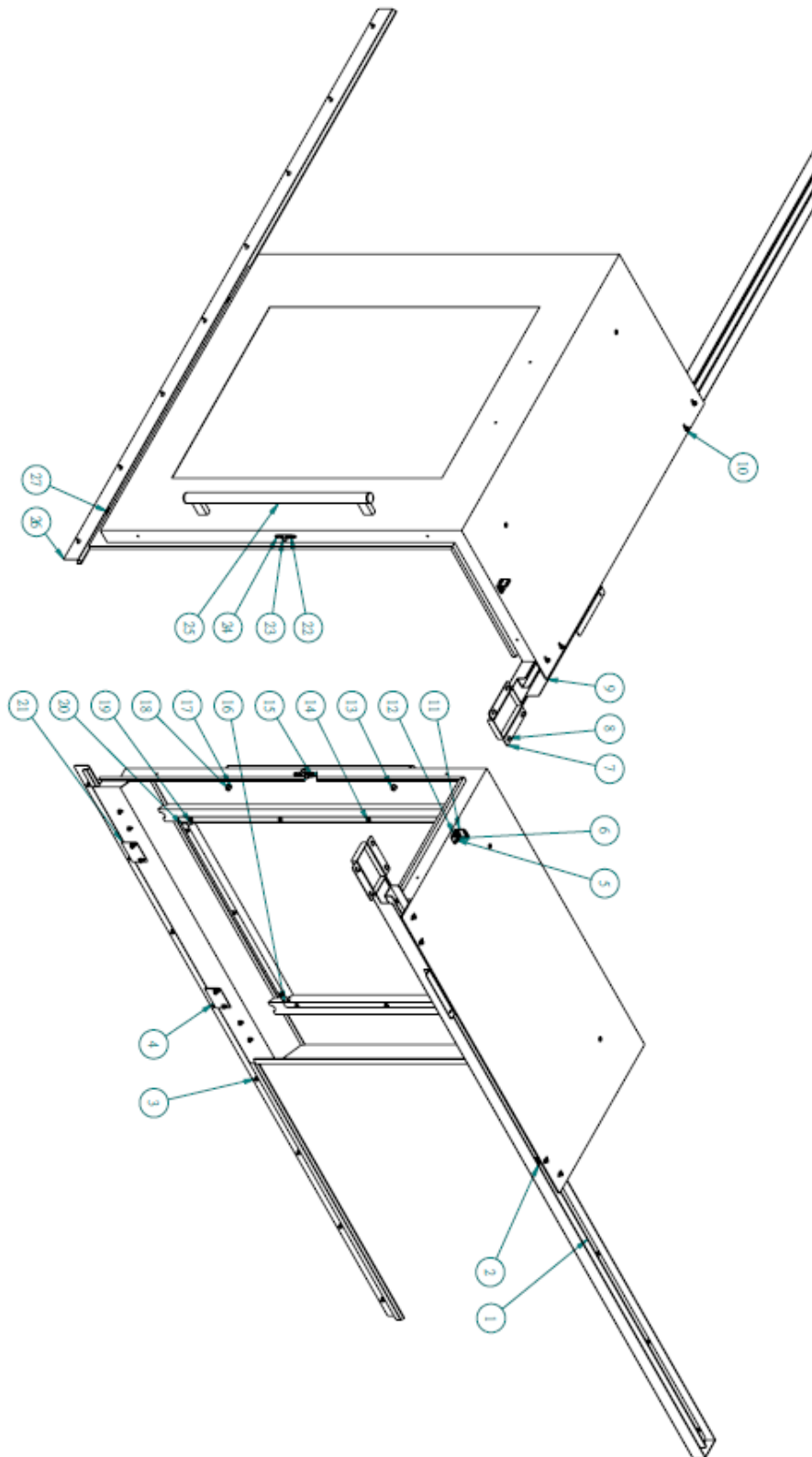



**PART LIST MANUAL**  
**SVL-4023 VERTICAL MACHINING CENTER**

NO.	PART NO.	PART NAME	SPECIFICATION	Q'TY	UNIT
1	B2071022000	Upper Track	2285Lx40Wx26H	1	EA
2	C0088019000	Bearing	636ZZ	4	EA
3	D0000040166	Hexagon Socket Head Cap Screws	M6xP1.0x16L	41	EA
4	D0010041001	Washer	M6	55	EA
5	D0010031206	Washer	M5	4	EA
6	D0000030126	Hexagon Socket Head Cap Screws	M5xP0.8x12L	2	EA
7	B2071022200	Upper Track Plate	2475Lx135Wx60H	1	EA
8	D0011040906	Spring Washer	M6	55	EA
9	B2071025200	Front Door	1393Lx1160Wx618H	1	EA
10	B2071025500	Front Door Upper Shaft	16Wx21L	4	EA
11	B2071025800	Fixed Plate	36.5Lx33Wx30H	1	EA
12	D0011030806	Spring Washer	M5	2	EA
13	D0000050206	Hexagon Socket Head Cap Screws	M8xP1.25x20L	2	EA
14	D0001040126	Hexagon Socket Button Head Cap Screws	M6xP1.0x12L	14	EA
15	B2071025700	Fixed Plate	75Lx20Wx2H	1	EA
16	B2071025600	Press Plate	1060Lx37Wx15H	2	EA





**PART LIST MANUAL**  
**SVL-4023 VERTICAL MACHINING CENTER**

NO.	PART NO.	PART NAME	SPECIFICATION	Q'TY	UNIT
17	D0010051301	Washer	M8	2	EA
18	D0011050146	Spring Washer	M8	2	EA
19	B2077000200	Acrylic	1015Lx745Wx6H	1	EA
20	B2071025400	Press Plate	734Lx37Wx15H	2	EA
21	B2071025300	Front Door Lower Plate	80Lx55Wx15H	2	EA
22	D0002020086	Countersunk Screws	M4xP0.5x8L	2	EA
23	C0088009300	Ball Catches	TK-69	1	EA
24	D0001030106	Hexagon Socket Button Head Cap Screws	M5xP0.8x10L	2	EA
25	C0579002000	Tubular Handle	MS-737-2-600	1	EA
26	B2071022100	Lower Track	2280Lx63Wx18.5H	1	EA
27	C0088019100	Lower Track Wheel	9022V49	2	EA

### 12、 MACHINERY COVERS ASSEMBLY UNIT

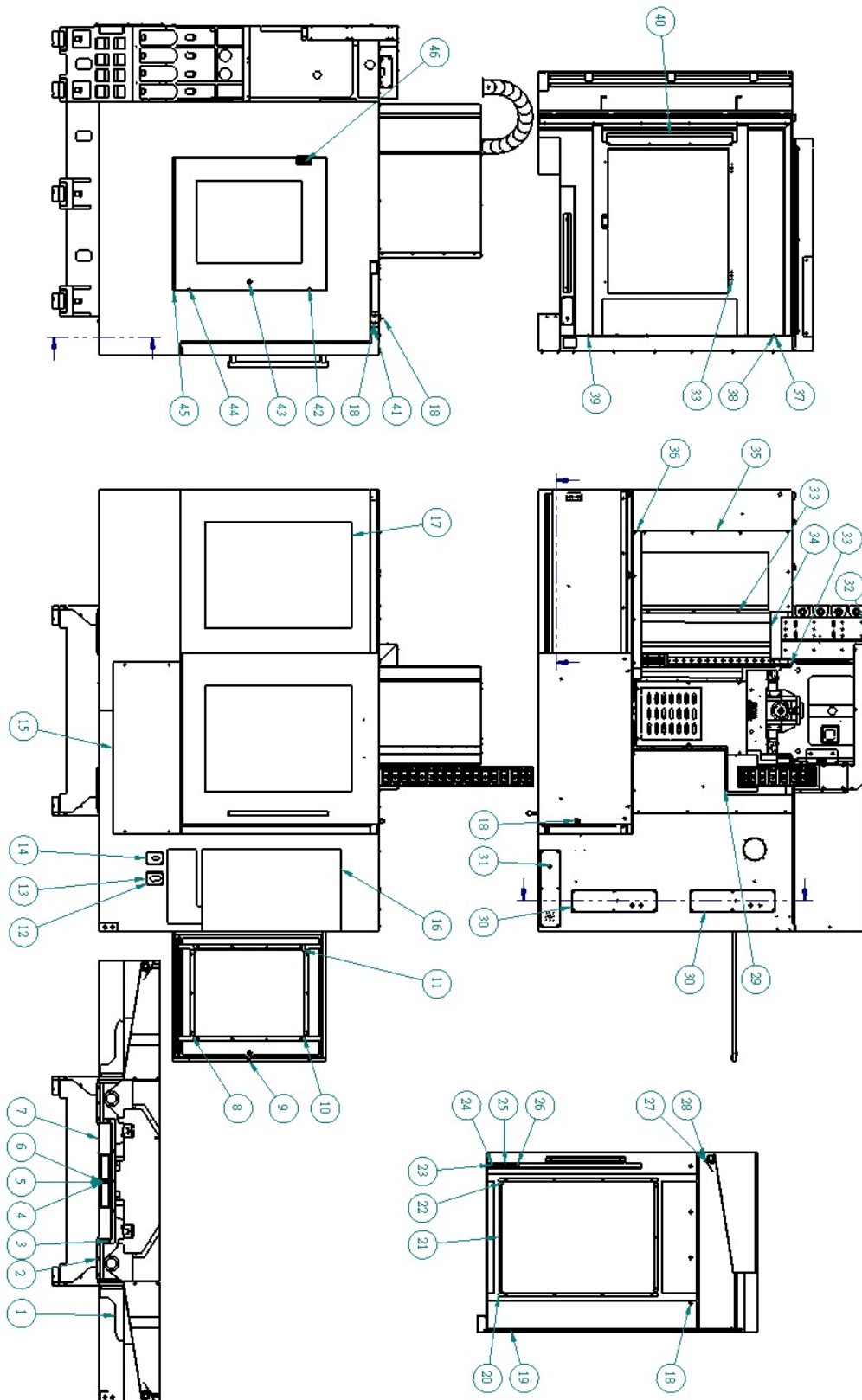



## PART LIST MANUAL SVL-4023 VERTICAL MACHINING CENTER

NO.	PART NO.	PART NAME	SPECIFICATION	Q'TY	UNIT
1	B2071026100	Support Frame	350Lx160Wx130H	4	EA
2	B2071004500	Plate	270Lx20Wx2H	2	EA
3	D0000040126	Hexagon Socket Head Cap Screws	M6xP1.0x12L	50	EA
4	D0000050206	Hexagon Socket Head Cap Screws	M8xP1.25x20L	21	EA
5	D0011050146	Spring Washer	M8	25	EA
6	D0010051301	Washer	M8	25	EA
7	B2071026000	Waterproof Cover	830Lx146Wx102H	1	EA
8	B2071026800	Press Plate	574Lx39Wx10H	4	EA
9	B2071026700	Right Door	1010Lx885Wx25H	1	EA
10	B2077000500	Acrylic	735Lx585Wx6H	2	EA
11	B2071026900	Press Plate	744Lx39Wx10H	4	EA
12	D0001030106	Hexagon Socket Button Head Cap Screws	M5xP0.8x10L	12	EA
13	B2071028400	Water Gun Plate	110Lx83Wx2H	1	EA
14	B2071028300	Air Gun Plate	110Lx83Wx2H	1	EA
15	B2071025900	Front Trim	1150Lx455Wx44H	1	EA
16	B2071027800	Right Cover	LxWxH	1	EA
17	B2071027000	Left Cover	LxWxH	1	EA



**PART LIST MANUAL**  
**SVL-4023 VERTICAL MACHINING CENTER**

NO.	PART NO.	PART NAME	SPECIFICATION	Q'TY	UNIT
18	B2071021700	Door Cover	1460Lx624Wx2H	1	EA
19	B2071027300	Press Plate	1060Lx37Wx15H	2	EA
20	B2071027200	Press Plate	734Lx37Wx15H	2	EA
21	B2077000200	Acrylic	1015Lx745Wx6H	1	EA
22	D0011030806	Spring Washer	M5	20	EA
23	D0000030126	Hexagon Socket Head Cap Screws	M5xP0.8x12L	16	EA
24	B2071021300	Working Lamp Cover	190Lx110Wx2H	2	EA
25	D0010031206	Washer	M5	28	EA
26	D0011040906	Spring Washer	M6	181	EA
27	B2071027400	Lower Water Deflector	1682Lx92.7Wx4.6H	2	EA
28	B2071021600	Up Covet	1065Lx420Wx30H	1	EA
29	B2071015100	Cover2	565Lx140Wx2H	2	EA
30	B2071028200	Warning Light Cover	515Lx130Wx2H	1	EA
31	B2071014700	Waterproof Plate	1020Lx465Wx49H	1	EA
32	D0000040166	Hexagon Socket Head Cap Screws	M6xP1.0x16L	120	EA
33	B2071025001	ATC Cover	978Lx378Wx142H	1	EA
34	B2071021700	Door Cover	1460Lx624Wx2H	1	EA



**PART LIST MANUAL**  
**SVL-4023 VERTICAL MACHINING CENTER**

NO.	PART NO.	PART NAME	SPECIFICATION	Q'TY	UNIT
35	B2071021901	Upper Cover	1000Lx990Wx2H	1	EA
36	B2071021800	Cover	919Lx63Wx18H	1	EA
37	B2071015000	4 Axis Plate	400Lx110Wx2H	1	EA
38	D0010041001	Washer	M6	187	EA
39	B2071027900	Trunk Cover	400Lx110Wx2H	1	EA
40	B2071027700	Lower Plate	844Lx78Wx18.4H	2	EA
41	B2071027100	Upper Fixing Plate	100Lx60Wx50H	1	EA
42	D0000040256	Hexagon Socket Head Cap Screws	M6xP1.0x25L	3	EA
43	C0088019300	Latches	A-705-1B	2	EA
44	D0000040206	Hexagon Socket Head Cap Screws	M6xP1.0x20L	1	EA
45	B2071026200	Left Door	1010Lx885Wx25H	1	EA
46	C0088019400	Hinges	BS-201-3G	4	EA

### 14、 POWER CANINET ASSEMBLY UNIT

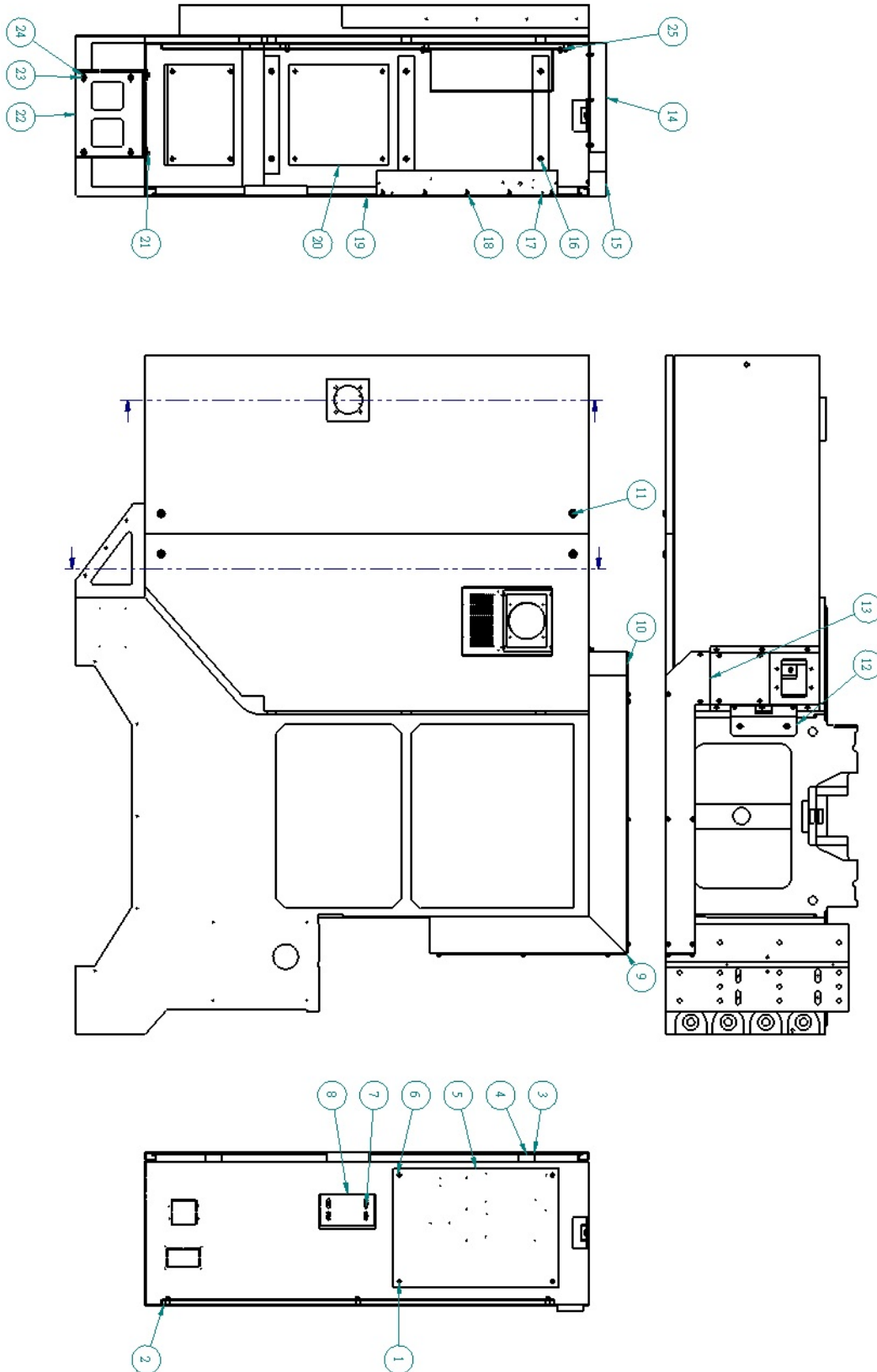



**PART LIST MANUAL**  
**SVL-4023 VERTICAL MACHINING CENTER**

NO.	PART NO.	PART NAME	SPECIFICATION	Q'TY	UNIT
1	D0000040126	Hexagon Socket Head Cap Screws	M6xP1.0x12L	59	EA
2	B2072000401	I/O Board	1310Lx1020Wx15H	1	EA
3	B2072000501	(L) Door , Power Cabinet	1418Lx570Wx32H	1	EA
4	B2072000200	Power Cabinet	1420Lx1140Wx452H	1	EA
5	B2072000301	I/O Board	530Lx380Wx15H	1	EA
6	D0011040906	Spring Washer	M6	48	EA
7	D0010041001	Washer	M6	77	EA
8	B2072000700	Main Power Switch Bracket	180Lx160Wx100H	1	EA
9	B2071015800	Cover	600Lx93Wx2H	1	EA
10	B2071015701	Cover	965Lx140Wx2H	1	EA
11	C0088018900	Lock	A-1403-20-30	4	EA
12	B2071015900	Conduit Bracket	210Lx100Wx90H	1	EA
13	B2071015600	Conduit Bracket Cover	192Lx167Wx90H	1	EA
14	B2071015501	Conduit Bracket	350Lx205Wx120H	1	EA
15	B2071013301	Conduit	935Lx600Wx170H	1	EA
16	D0000050206	Hexagon Socket Head Cap Screws	M8xP1.25x20L	12	EA
17	C0088000200	Heat Exchanger	EA2AR-H22	1	EA



**PART LIST MANUAL**  
**SVL-4023 VERTICAL MACHINING CENTER**

NO.	PART NO.	PART NAME	SPECIFICATION	Q'TY	UNIT
18	D0012040056	NUT	M6xP1.0	10	EA
19	B2072000600	(R) Door , Power Cabinet	1418Lx595Wx32H	1	EA
20	B2072000800	I/O Board	320Lx320Wx15H	2	EA
21	D0000040166	Hexagon Socket Head Cap Screws	M6xP1.0x16L	8	EA
22	B2072000100	Power Cabinet Bracket	300Lx280Wx220H	1	EA
23	D0011050146	Spring Washer	M8	12	EA
24	D0010051301	Washer	M8	12	EA
25	B2072000901	Fixed Bracket Driver	520Lx455Wx135H	1	EA



### 15、 FRONT COOLANT TANK ASSEMBLY UNIT

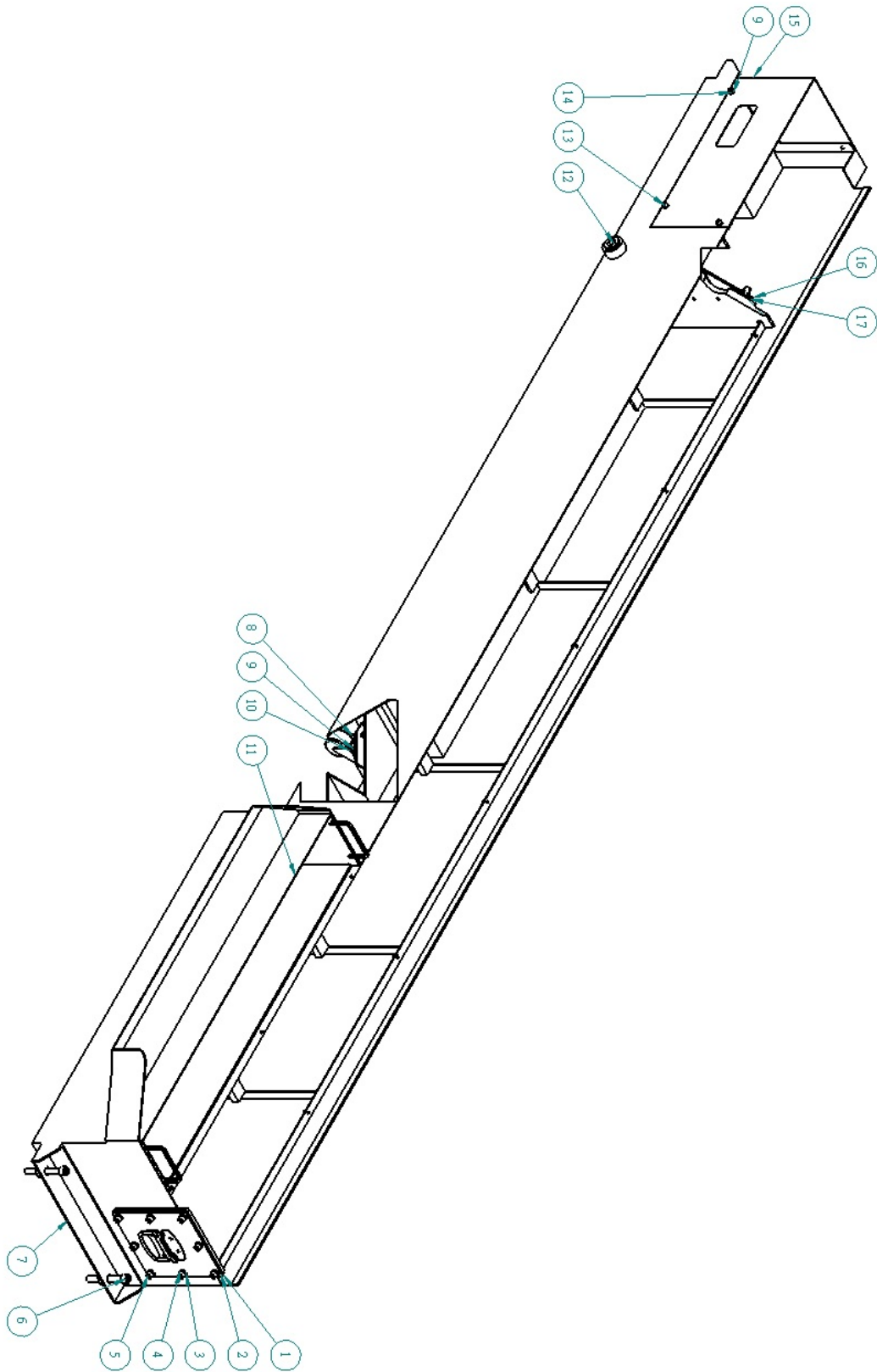



## PART LIST MANUAL SVL-4023 VERTICAL MACHINING CENTER

NO.	PART NO.	PART NAME	SPECIFICATION	Q'TY	UNIT
1	B2071023900	Waterproof Film	185Lx185Wx3H	1	EA
2	B2071024000	Coolant Tank Cover	185Lx185Wx11.5H	1	EA
3	D0010051301	Washer	M8	14	EA
4	D0011050146	Spring Washer	M8	14	EA
5	D0000050206	Hexagon Socket Head Cap Screws	M8xP1.25x20L	14	EA
6	D0000070906	Hexagon Socket Head Cap Screws	M12xP1.75x90L	4	EA
7	B2071020102	Coolant Tank	3320Lx528Wx310H	1	EA
8	C0073000300	Caster	1109-02-29-2	5	EA
9	D0010041001	Washer	M6	26	EA
10	D0000040166	Hexagon Socket Head Cap Screws	M6xP1.0x16L	20	EA
11	B2071026500	Chip Box	942Lx305Wx145H	1	EA
12	D0030280006	Screw Plugs	1PT	1	EA
13	D0000040126	Hexagon Socket Head Cap Screws	M6xP1.0x12L	6	EA
14	D0011040906	Spring Washer	M6	6	EA
15	B2071024301	Coolant Tank Cover	432Lx206Wx194H	1	EA
16	B2071024200	Coolant Tank Cover	155Lx120Wx3H	1	EA
17	B2071024100	Waterproof Film	150Lx120Wx3H	1	EA

### 16、 COOLANT TANK ASSEMBLY UNIT

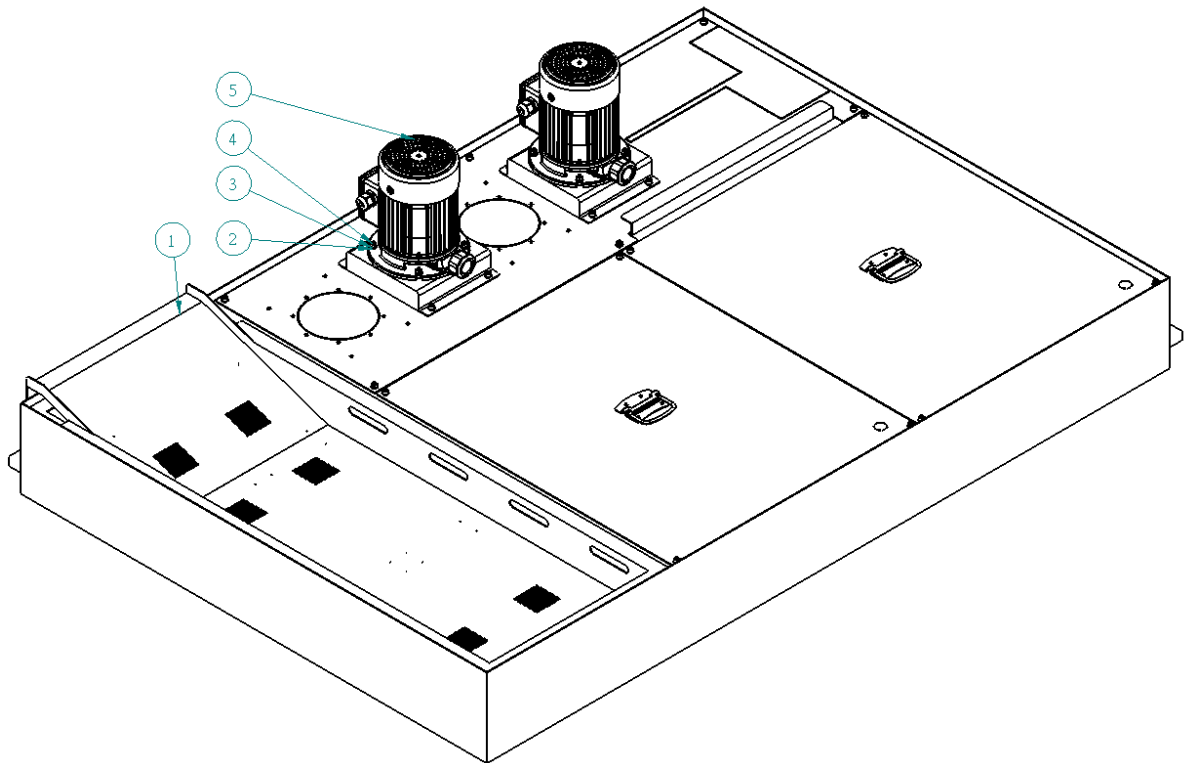



**PART LIST MANUAL**  
**SVL-4023 VERTICAL MACHINING CENTER**

NO.	PART NO.	PART NAME	SPECIFICATION	Q'TY	UNIT
1	B2071017200	Coolant Tank	1740Lx1160Wx180H	1	SET
2	D0010041001	Washer	M6	8	EA
3	D0011040906	Spring Washer	M6	8	EA
4	D0000040256	Hexagon Socket Head Cap Screws	M6xP1.0x25L	8	EA
5	C0788000400	Pump	TPHK4T 4-4	2	EA

### 17、 OPERATION BOX ASSEMBLY UNIT

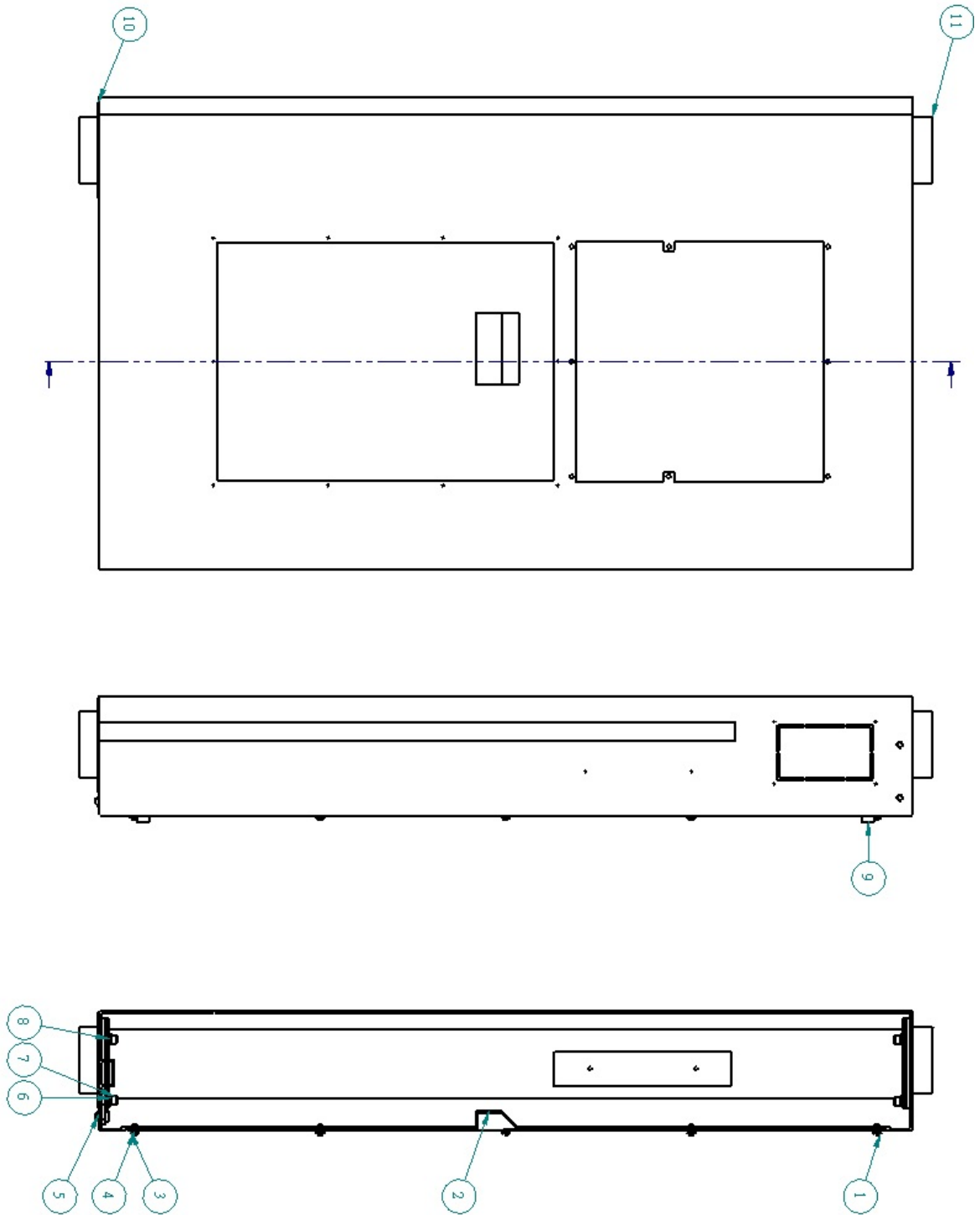



**PART LIST MANUAL**  
**SVL-4023 VERTICAL MACHINING CENTER**

NO.	PART NO.	PART NAME	SPECIFICATION	Q'TY	UNIT
1	D0001030106	Hexagon Socket Button Head Cap Screws	M5xP0.8x10L	12	EA
2	B2473000600	Operation Box Cover	858Lx448Wx22H	1	EA
3	D0011030806	Spring Washer	M5	12	EA
4	D0010031206	Washer	M5	12	EA
5	C0071000600	Spring Plungers	978-H-26(5/16)	2	EA
6	D0011040906	Spring Washer	M6	6	EA
7	D0000040126	Hexagon Socket Head Cap Screws	M6xP1.0x12L	6	EA
8	D0010041001	Washer	M6	6	EA
9	C0071000500	Cushion	D15x7	2	EA
10	B2076000300	Operation Box	920Lx535Wx135H	1	EA
11	B2071021500	Operation Box Shaft	D100x34L	2	EA

### 18、 SPINDLE HEAD SHEET METAL ASSEMBLY UNIT

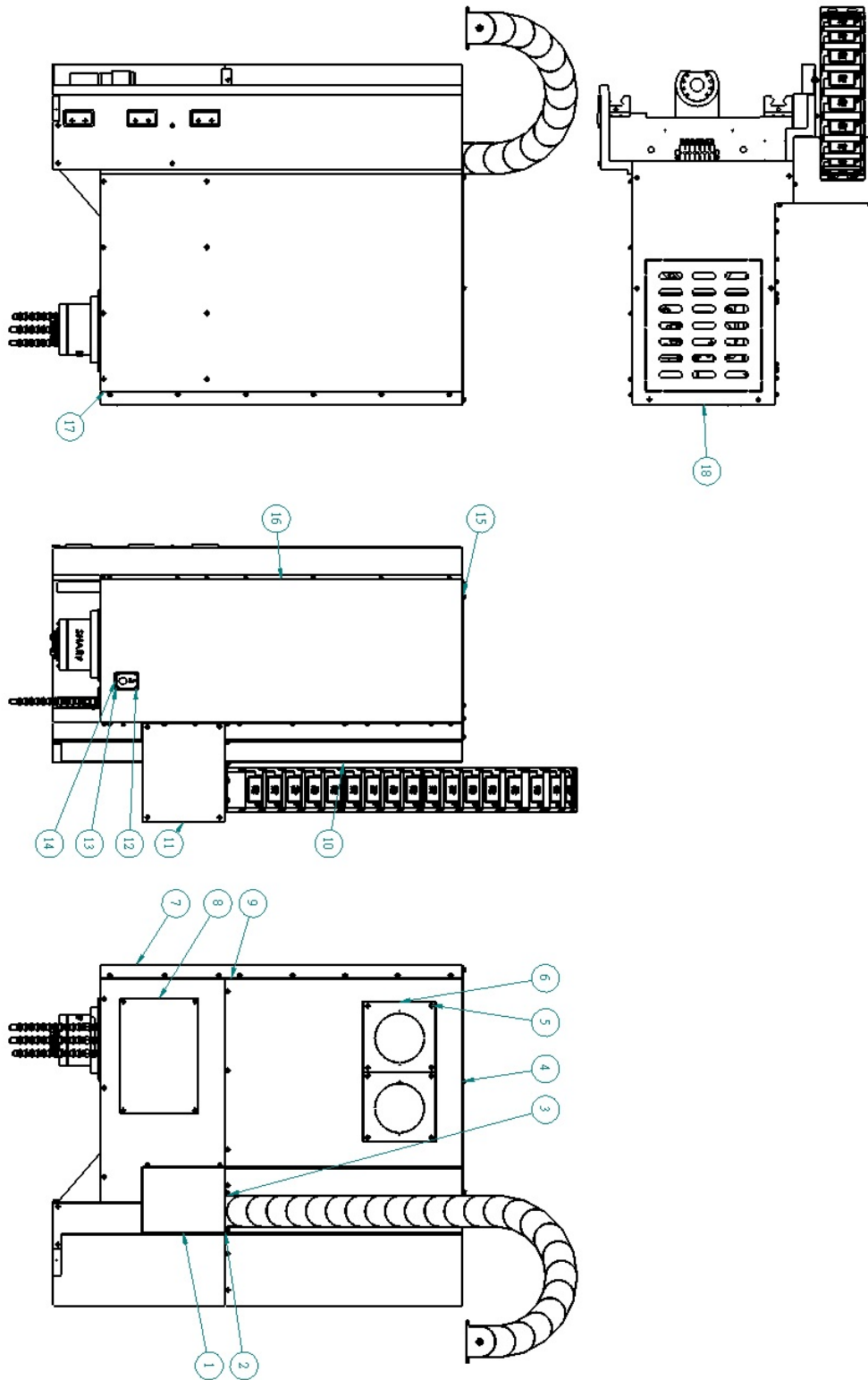



**PART LIST MANUAL**  
**SVL-4023 VERTICAL MACHINING CENTER**

NO.	PART NO.	PART NAME	SPECIFICATION	Q'TY	UNIT
1	B2071016000	Right Wire Conduit Cover	750Lx398Wx345H	1	EA
2	E2082000700	Wire Conduit , Z AXIS	ASQ303-KR200-IV-NO.06	1	EA
3	D0000050206	Hexagon Socket Head Cap Screws	M8xP1.25x20L	4	EA
4	D0010041001	Washer	M6	68	EA
5	D0000040126	Hexagon Socket Head Cap Screws	M6xP1.0x12L	68	EA
6	B2071017100	Fan Cover	219Lx211.5Wx2H	2	EA
7	D0001010086	Hexagon Socket Button Head Cap Screws	M3xP0.5x8L	4	EA
8	B2071023600	Cover	348Lx236Wx2H	1	EA
9	B2071016101	Right Cover	913Lx156Wx139H	1	EA
10	B2071016601	Left Cover	1013Lx720Wx147H	1	EA
11	B2071017000	Wire Conduit Cover	300Lx250Wx2H	1	EA
12	D0010010001	WASHER	M3	4	EA
13	D0011010006	SPRING WASHER	M3	4	EA
14	E0282000900	Name Plate	70Lx50Wx2H	1	EA
15	D0011040906	Spring Washer	M6	68	EA
16	B2071018000	Front Rear Cover	1190Lx436Wx71H	1	EA





**PART LIST MANUAL**  
**SVL-4023 VERTICAL MACHINING CENTER**

NO.	PART NO.	PART NAME	SPECIFICATION	Q'TY	UNIT
17	B2071018100	(R) Rear Cover	1242Lx948Wx123H	1	EA
18	B2071023801	Up Rear Cover	740Lx490Wx2H	1	EA